

Project No. 14: Centralvale Road - HWY 35 to WyEast

Estimated Project Cost: \$1,315,875

Project Priority: High

Project Description

A total of 5,500ft of 10-in diameter waterline will be installed along Centralvale Drive, beginning at Booth Hill Road and ending at WyEast Road, replacing existing 4-in waterline. The upsized waterline will improve fire flows and distribution capacity to the west side of Odell and reduce high flow velocities through this section. The upsized line will also serve as a portion of the primary supply line to the new West Side Reservoir.

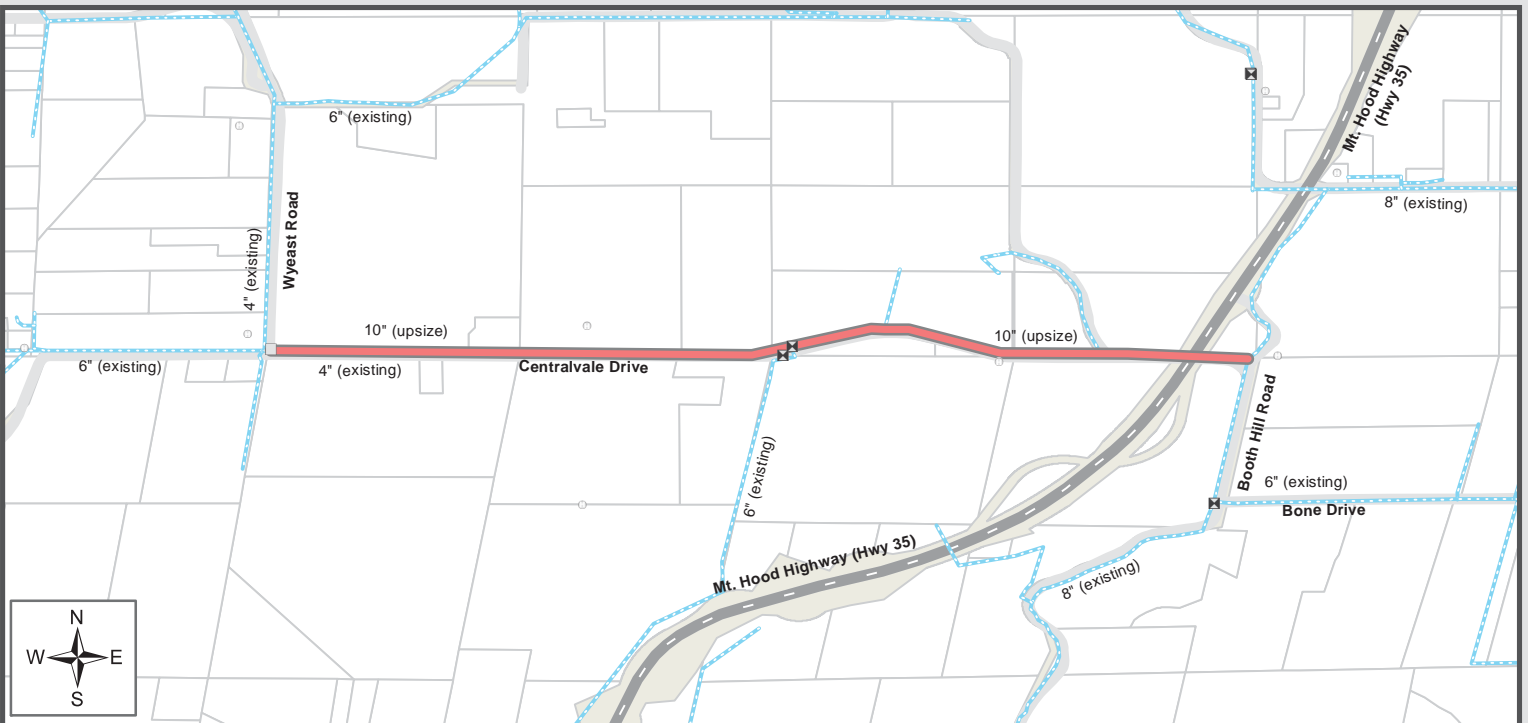
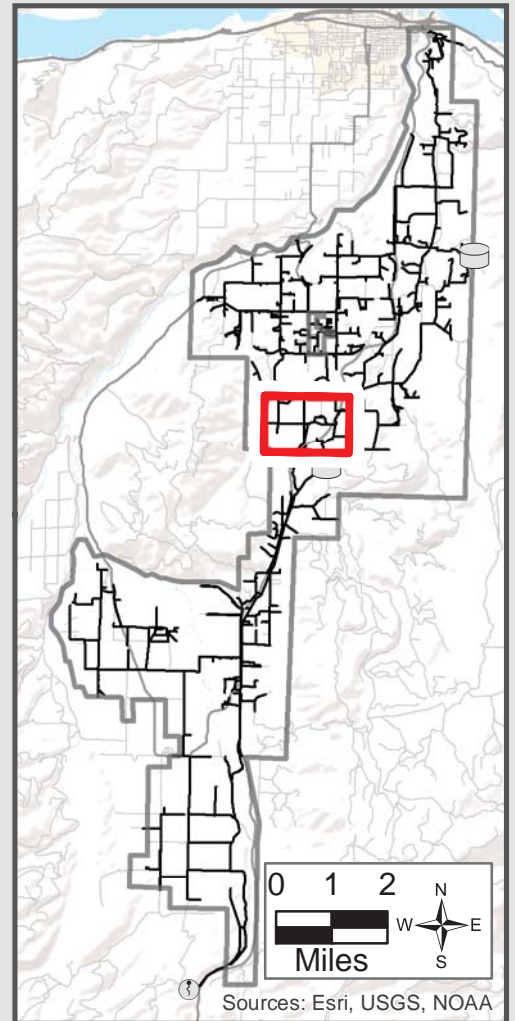

Upsized Waterline	Relief Valve	Crystal Spring	Highway/Road
New Waterline	Hydrants	Existing Reservoir	Property line
New PRV	Existing Reservoir	Existing Waterline	Water
New Reservoir	0 1,000 Feet		
PRV Existing			

